

430 N Franklin Street

Lancaster, PA 17603

Building Information

- Construction: Concrete
- Ceiling Height: 15'-18'
- Roof: Rubber
- Electric: 200+ Amp; 3 Phase
- Year Built: 1967
- Drive-in Doors: One (1)
- Drive-in Door Height: 8'-12'
- Loading Dock(s): One (1)

Site Information

- Lot Size: 2.6 Acres
- County: Lancaster
- Municipality: Lancaster City
- Parking: Parking Lot
- Water: Public
- Sewer: Public
- Tax ID #'s: 336-22449-0-0000
- Zoning: Central Manufacturing



UNIT B	4,500 SF
UNIT C	4,500 SF
TOTAL SF	9,000 SF

For more information:

Thomas M. McDermott, CCIM, SIOR
+1 717 735-6000 Ext. 111
tom@uscommercialrealty.net

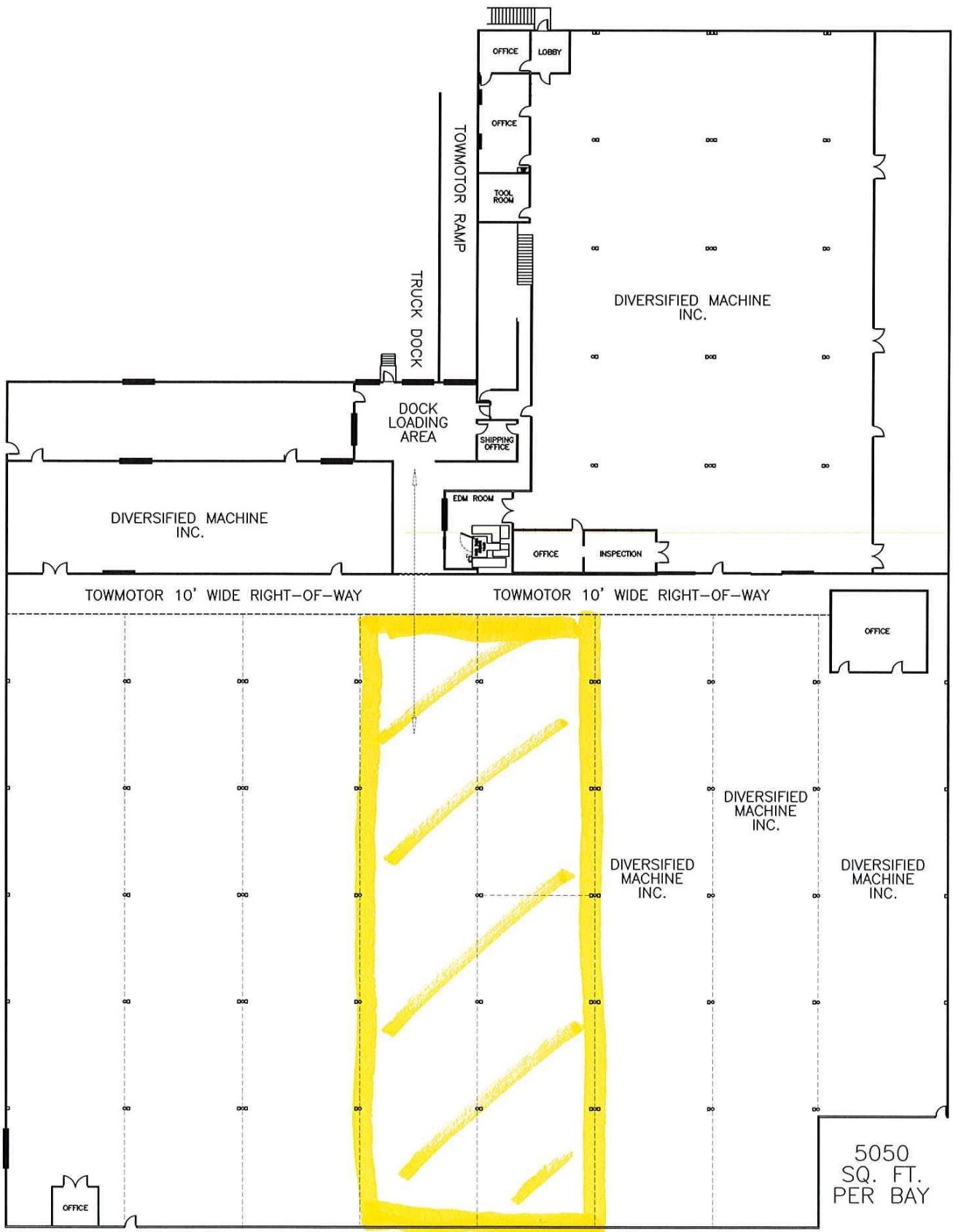

DIVERSIFIED MACHINE INC.

DIVERSIFIED MACHINE INC.

TOWMOTOR 10' WIDE RIGHT-OF-WAY

TOWMOTOR 10' WIDE RIGHT-OF-WAY

OFFICE

DIVERSIFIED MACHINE INC.

DIVERSIFIED MACHINE INC.

DIVERSIFIED MACHINE INC.

5050
SQ. FT.
PER BAY

OFFICE